

DVA[®]
DE VECCHI S.R.L.

WATER **SOFTENERS**



SERIES ERA

WATER SOFTENERS

DVA[®]
DE VECCHI S.R.L.

WHY DO I NEED A WATER SOFTENER?

Water supplied by the water supply network, despite the fact that it is top quality, is rich in mineral salts which cause scaling problems. Softeners are dedicated devices that have been designed to avoid problems caused by water rich in mineral salts. Regeneration is crucial so as to have correct softeners operation. Store managers have always been in charge of such procedure...so far!

A NEW "ERA" IS ABOUT TO START!



ERV Valve



Valve Installation



Regeneration Gearcase

The **ERA** system provides a very easy procedure so as to streamline softener operations from installation to regeneration.

Thanks to the **ERA** system, installers will be in the position to provide a comprehensive service to their customers, from product supply to service.

Store managers will not have to care anymore about maintenance, repair and even regeneration procedures.

The technical engineer will be in the position to cover the full service.

BENEFITS OF THE "ERA" SYSTEM

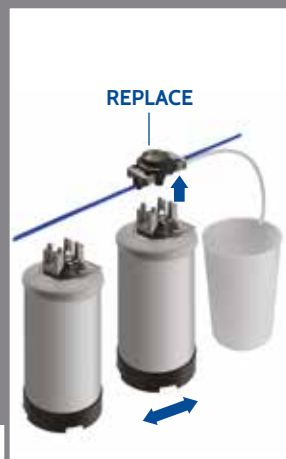
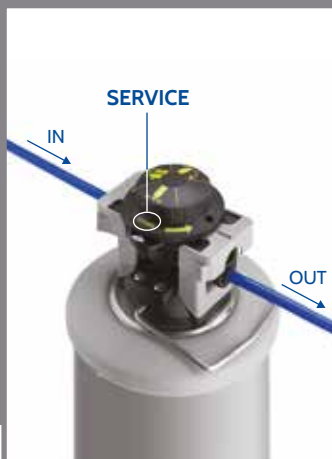

Swift softener installation by a simple "click".

The softener can be replaced by a reconditioned device at any time.

Replacement is fast and does not stop the water flow.

If a softener provides water to a coffee machine, coffee supply will not be disrupted during softener replacement.

A REVOLUTIONARY REGENERATION SYSTEM!

Softeners can be regenerated in a different location from where they have been installed.

Thanks to "ERA", softeners can be regenerated by simply pressing a key.

The regeneration gearcase allows for simultaneous refill of up to three cylinders having the same size (up to ER 1 2).

Reconditioned softeners can be used straightaway.

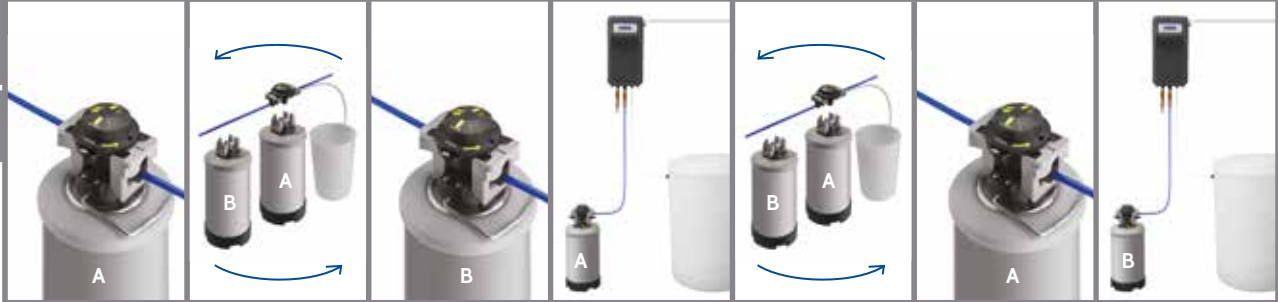

ONE SINGLE VALVE FITTING 8 MODELS

The "ERA" system is made up of 8 different models.

The valve connecting to the waterworks can be fixed to anyone of them.

Multiple softeners can be installed in the same store based on actual consumption.

Moreover they can be replaced so as to install a bigger or a smaller one according to needs.

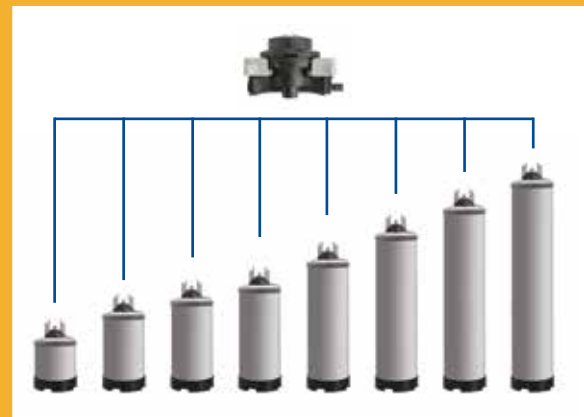

INSTALLATION LOCATIONS

They are a must-have in the catering business, in services targeting bars, in vending machines selling hot beverages and, more generally speaking, in whatever place where water is used as raw material. For instance, it is a prerequisite in coffee machine to enhance coffee aroma.

It is also useful for dishwashers, icemakers, steam ovens and so on and so forth..



CHECK THE SOFTENER LIFECYCLE!

The label at the back of the softener will be helpful for maintenance purposes.

Installation and reconditioning dates can be noted there.



GEARING UP TOWARDS GREATER SAVINGS

The store manager can monitor water consumption for each installed softener by means of simple calculations that are also useful to draw up a cost optimization programme.

“ERA” SERIES MODELS

Models featuring the “ERV” valve:

ER5, ER8, ER10, ER12, ER14, ER16, ER18, ER20



SOFTENED AMOUNT OF WATER

TECHNICAL SPECIFICATIONS

WATER HARDNESS			
°f	20	30	40
°d	11	16	22
ppm CaCO ₃	200	300	400
ER5	1050	700	525
ER8	1680	1120	840
ER10	2100	1400	1050
ER12	2520	1680	1260

WATER HARDNESS			
°f	20	30	40
°d	11	16	22
ppm CaCO ₃	200	300	400
ER14	2940	1960	1470
ER16	3360	2240	1680
ER18	3780	2520	1890
ER20	4200	2800	2100



Water Pressure	min 2 bar - max 6 bar
Room Temperature	min 4°C - max 35°C
Water temperature	min 4°C - max 25°C
Max Flow Rate	700 l/h
Salt in Brine	max 80 kg

POWER SUPPLY	
INPUT Standard	230V 50/60 Hz
INPUT Optional	120V 60 Hz
OUTPUT	15V DC
Power Absorbed	15 W

SUPPLY WATER FEATURES

- drinking water
- min 4°C - max 25°C temperature
- 90°F max hardness



DVA[®]
DE VECCHI S.R.L.

De Vecchi srl società unipersonale
Via V. Alfieri, 15 - 20872 Cornate d'Adda fraz. Colnago (MB) Italia - Tel. 039.695355 - Fax 039.6095181
www.devecchigaetano.com - info@devecchigaetano.com